

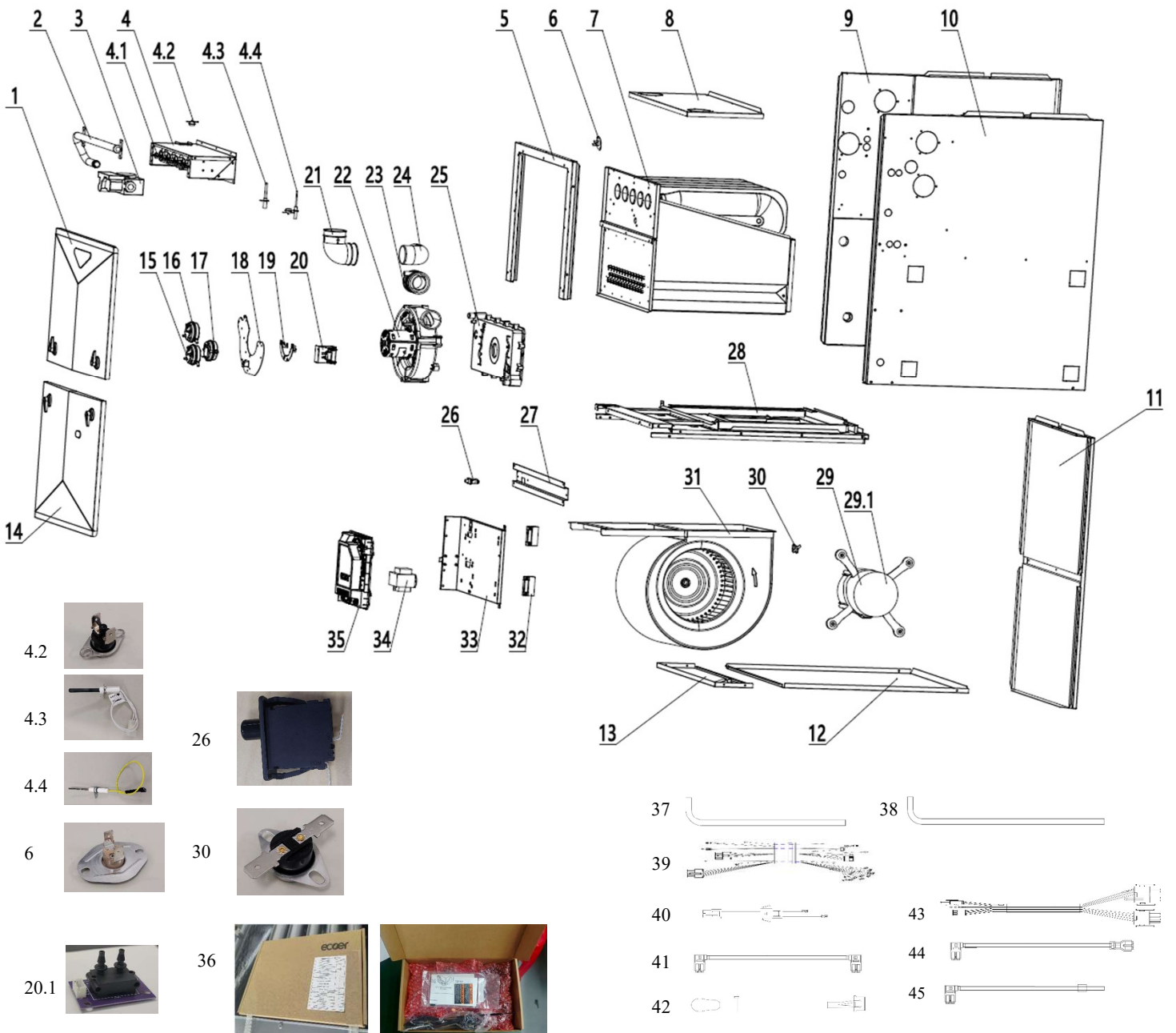

# Parts List for Ecoer DFi 98% Furnace

## EVMF98M28080B3L/EVMF98M35100C5L



No.	Part Name	EVMF98M28080B3L		EVMF98M35100C5L		Recommend aftersales
		Quantity	BOM code	Quantity	BOM code	
1	Front panel (Upper)	1	E.AC.2308400063	1	E.AC.2308400104	
2	Gas pipe assembly (44#)	1	E.AC.2322100005	1	E.AC.2322100011	
3	Gas valve	1	E.AC.2309100051	1	E.AC.2309100051	✓
4	Burner assembly	1	E.AC.2308400015	1	E.AC.2308400078	
4.1	Burner	4	E.AC.2322100003	5	E.AC.2322100003	
4.2	Flame Rollout (300F)	2	E.AC.2309100054	2	E.AC.2309100054	✓
4.3	Igniter	1	E.AC.2309100052	1	E.AC.2309100052	✓
4.4	Flame sensor	1	E.AC.2309100053	1	E.AC.2309100053	✓
5	Heat exchanger mounting frame	1	E.AC.2308400014	1	E.AC.2308400077	
6	Outlet High Temperature Limit Switch (180°F)	1	E.AC.2309100048	1	E.AC.2309100048	✓
7	Heat exchanger assembly	1	E.AC.2308400001	1	E.AC.2308400071	
8	Top panel	1	E.AC.2308400060	1	E.AC.2308400099	
9	Left panel	1	E.AC.2308400050	1	E.AC.2308400050	
10	Right panel	1	E.AC.2308400053	1	E.AC.2308400053	
11	Back panel	1	E.AC.2308400056	1	E.AC.2308400097	
12	Bottom return plate	1	E.AC.2308400062	1	E.AC.2308400103	
13	Bottom support plate	1	E.AC.2308400061	1	E.AC.2308400100	
14	Front panel (Lower)	1	E.AC.2308400067	1	E.AC.2308400108	
15	Pressure switch (Low) 0.55	1	E.AC.2309100046	1	E.AC.2309100046	✓
16	Pressure switch (Middle) 0.75	1	E.AC.2309100047	1	E.AC.2309100047	✓
17	Pressure switch (High) 1.1	1	E.AC.2309100045	1	E.AC.2309100045	✓
18	Pressure switch mounting plate	1	E.AC.2308400026	1	E.AC.2308400026	
19	Pressure switch mounting bracket	1	E.AC.2308400024	1	E.AC.2308400024	
20	Pressure switch assembly	1	E.AC.2308400159	1	E.AC.2308400159	
20.1	Pressure switch terminal Board	1	E.AC.230907002	1	E.AC.230907002	✓
21	Inducer Elbow (flexible)	1	E.AC.2307100023	1	E.AC.2307100023	
22	Inducer	1	E.AC.2323100011	1	E.AC.2323100011	✓
23	Inducer elbow (rigid)	1	E.AC.2307100022	1	E.AC.2307100022	
24	Inducer flexible connector	1	E.AC.2307100021	1	E.AC.2307100021	
25	Drain box	1	E.AC.2307100019	1	E.AC.2307100019	
26	Door switch	1	E.AC.2309100050	1	E.AC.2309100050	✓
27	Panel mounting bracket	1	E.AC.2308400041	1	E.AC.2308400093	
28	Blower partition panel	1	E.AC.2308400029	1	E.AC.2308400084	
29	Motor assembly	1	E.AC.2323100009	1	E.AC.2323100010	
29.1	Constant air volume motor	1	E.AC.2323100006	1	E.AC.2323100007	✓
30	Reflow High Temperature Limit Switch (120°F)	2	E.AC.2309100049	2	E.AC.2309100049	✓
31	Centrifugal fan	1	E.AC.2308400095	1	E.AC.2308400095	
32	Hinge	2	E.AC.2322100007	2	E.AC.2322100007	
33	Main control board mounting plate	1	E.AC.2308400047	1	E.AC.2308400047	
34	Transformer	1	E.TFR.020004	1	E.TFR.020004	✓
35	Main control board assembly	1	E.AC.2314100009	1	E.AC.2314100009	✓
36	Accessory kit	1	E.AC.2313100013	1	E.AC.2313100013	✓
37	Drain pipe-φ16	1	E.AC.2321100049	1	E.AC.2321100049	
38	Drain pipe-φ14	2	E.AC.2321100050	2	E.AC.2321100050	
39	Wire harness	1	E.CAB.000003	1	E.CAB.000003	
40	Reverse flow thermal switch connect wire	1	E.CAB.030003	1	E.CAB.030003	
41	Reverse flow switch connect wire	1	E.CAB.030004	1	E.CAB.030004	
42	T1 temperature sensor	1	E.AC.2309100026	1	E.AC.2309100026	✓
43	Motor wiring harness	1	E.CAB.040005	1	E.CAB.040005	
44	Reflow High Temperature Limit Switch wire	1	E.CAB.030005	1	E.CAB.030005	
45	Door switch power cable	1	E.CAB.001002	1	E.CAB.001002	

©2025 ECOER INC.

4040 McDermott Road, Suite 200 Plano, Texas 75024  
Tel: 703-348-2538

[www.ecoer.com](http://www.ecoer.com)