



Multi-position Air Handler
EAHATN-48

TAG:

SUBMITTAL

NOTE: 25" CLEARANCE IS REQUIRED IN THE FRONT OF THE UNIT FOR FILTER AND COIL MAINTENANCE.

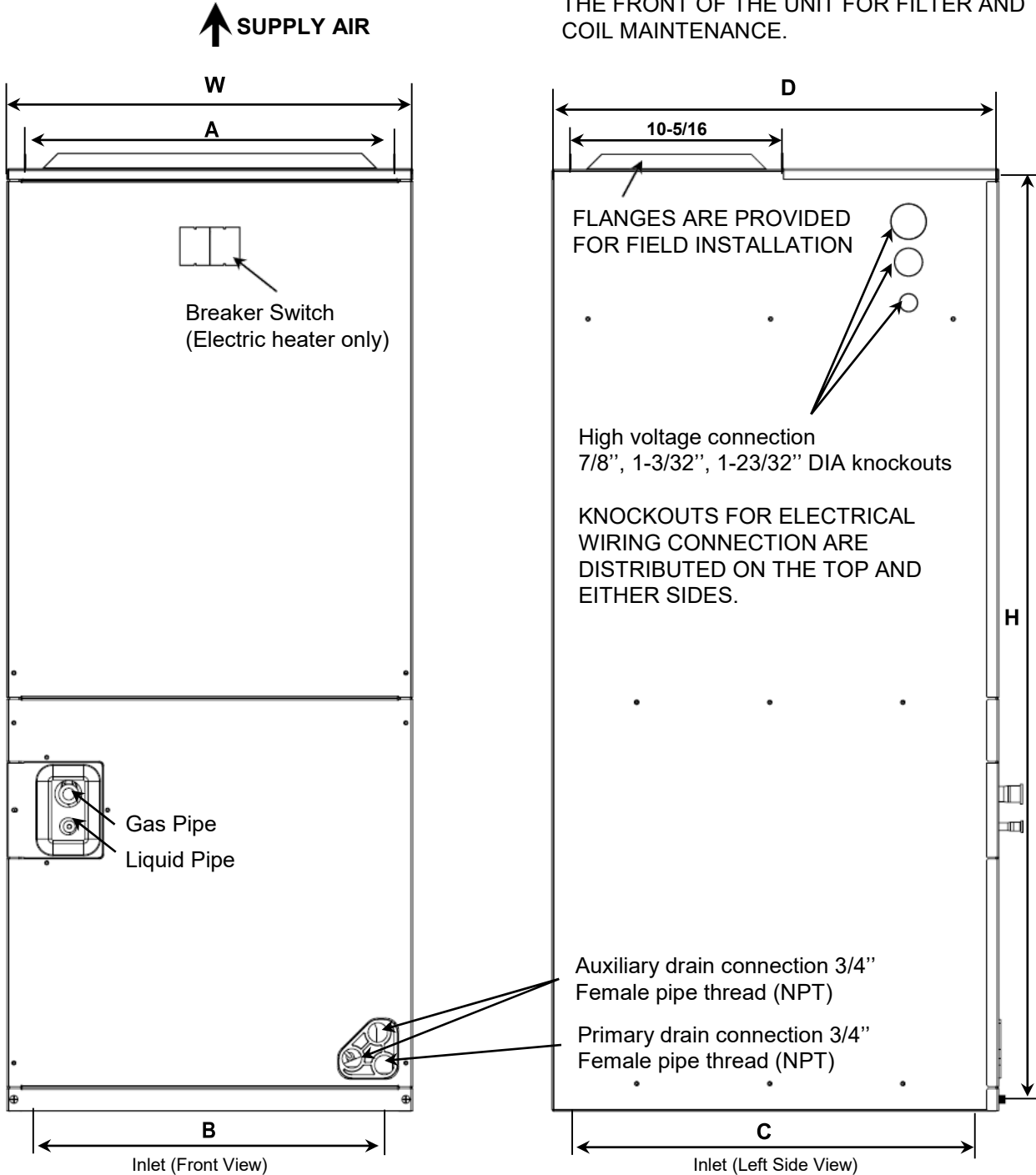

Model	Dimensions (in.)					
	H	W	D	A	B	C
EAHATN-48	56	24-1/2	21	22-3/4	15-1/4	16

Product Specifications

MODEL	EAHATN-48
Voltage-Phase-Hz	208/230-1-60
Minimum Circuit Amps.	7.5
INDOOR COIL TYPE	Plate Fin
Rows	4
Tube Size	3/8
Refrigerant Control	TXV
Drain Connection Size (in.)	3/4 NPT
Duct Connections	See Outline Drawing
INDOOR FAN TYPE	Centrifugal
Blower Diameter-Width (in.)	11 X 10-5/8
Fan Motor Type	ECM
CFM vs. in. W.G	See Fan Performance Table
Fan Motor HP	3/4
FLA	6.0
Filter Size (in.)	23*20
Filter equipped from factory	NO
Refrigerant	R-410A
Ref. Pipe Connections	Brazed
Liquid Pipe Size (in. O.D.)	3/8
Gas Pipe Size (in. O.D.)	7/8
Dimensions (W X H X D)	24-1/2 x 56 x 21
Net Weight (LBS)	172
Shipping Weight (LBS)	207

Product Specifications (Continued)

FAN SPEED	Sound pressure level (dB)
High	67
Medium High	63
Low	61

Model Number	Motor Speed	CFM (Watts)										
		External Static Pressure-Inches W.C.[KPa]										
		0 [0]	0.1 [0.02]	0.16 [.04]	0.2 [0.05]	0.3 [0.07]	0.4 [0.10]	0.5 [0.12]	0.6 [0.15]	0.7 [0.17]	0.8 [0.20]	
48	Tap (5)	SCFM	2144	2106	2072	2052	2015	1962	1924	1864	1823	1768
		Watts	627	632	639	643	649	661	670	681	684	696
	Tap (4)	SCFM	1999	1966	1933	1915	1875	1819	1775	1713	1672	1582
		Watts	510	520	529	536	540	551	555	567	571	588
	Tap (3) – factory	SCFM	1788	1746	1714	1695	1660	1606	1565	1499	1452	1355
		Watts	367	374	389	393	404	422	429	440	449	458
	Tap (2)	SCFM	1633	1596	1564	1554	1514	1467	1424	1342	1290	1231
		Watts	292	300	311	318	329	343	354	376	382	391
	Tap (1)	SCFM	1504	1468	1428	1408	1362	1298	1244	1182	1160	1081
		Watts	228	242	250	255	264	279	291	309	318	327

Heater Kit Model	Electric Heater (kW)	MIN. Circuit Ampacity		MAX. Fuse or Breaker(HACR) Ampacity		Fan Speed				
		240	208	240	208	1	2	3	4	5
E-EHK05	5	25	22	30	25	x	●	●	●	●
E-EHK10	10	49	43	60	50	x	●	●	●	●
E-EHK15	5+10	25+49	22+43	30+60	25+50	x	x	●	●	●
E-EHK20	10+10	49+49	43+43	60+60	50+50	x	x	x	●	●

Mechanical Specifications

1. Multi-position Installation. (Vertical up-flow and horizontal right-flow from factory; field convertible to horizontal left-flow or vertical down-flow *Refer to installation manual for details)
2. Multiple electrical entry locations.
3. Field installed heater kits 5,10, 15, 20KW.
4. Dual front panel design for ease of maintenance.
5. ECM 3 speed options (Tap 3 - Tap 5) in the job site. Two-stage speed is available to get even better dehumidification control if cooperating with Ecoer thermostat.
6. Blower and coil easy slide out design for ease of maintenance.
7. Horizontal and vertical condensate drain pans.
8. Condensate drain is polymer with UVC inhibitor.
9. Primary and secondary condensate drain fittings.

