



Multi-position Air Handler EAHATN-36

TAG:

SUBMITTAL

NOTE: 25" CLEARANCE IS REQUIRED IN THE FRONT OF THE UNIT FOR FILTER AND COIL MAINTENANCE.

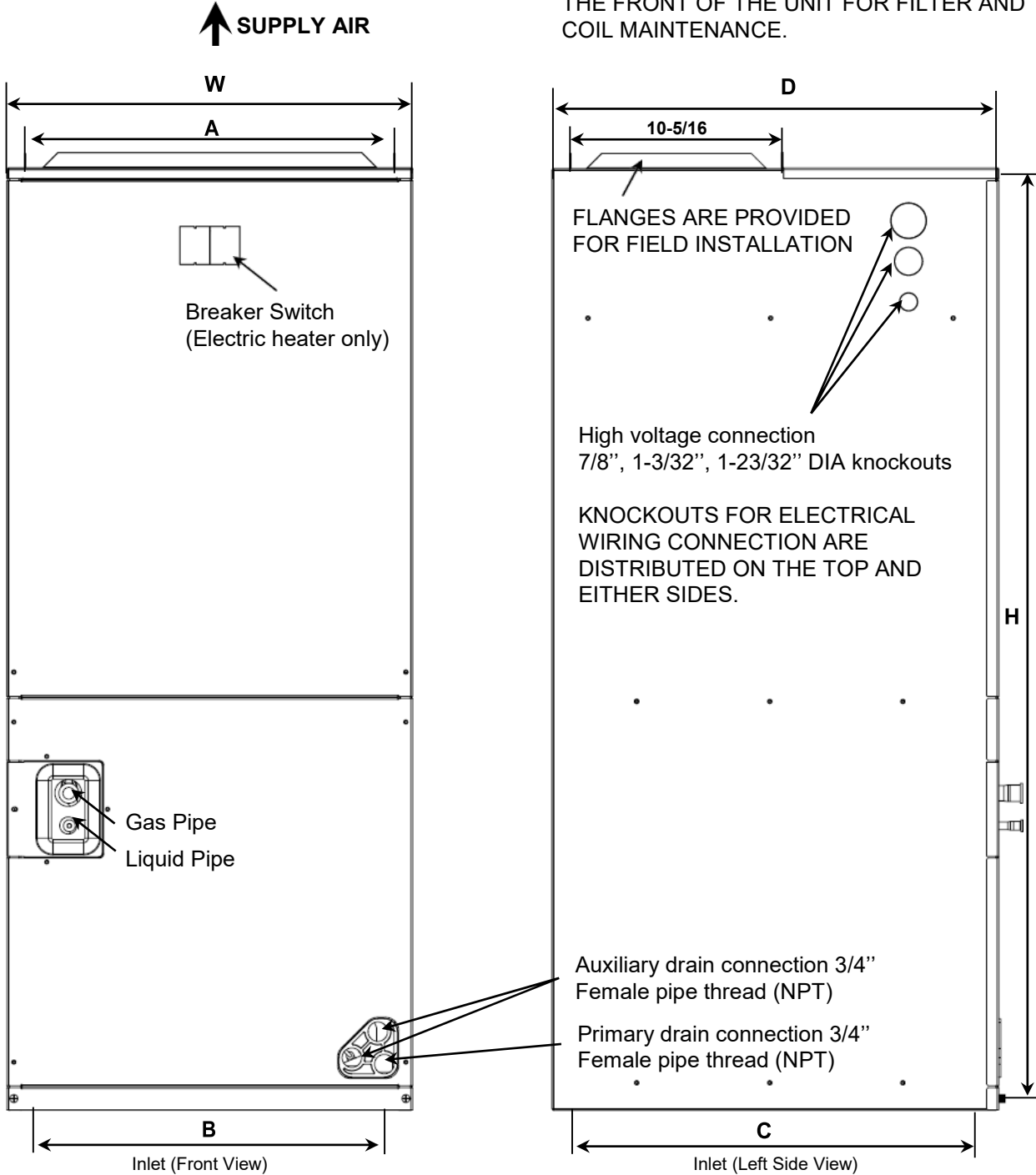

Model	Dimensions (in.)					
	H	W	D	A	B	C
EAHATN-36	46-1/2	21	21	19-1/4	13-7/8	16

Product Specifications

MODEL	EAHATN-36
Voltage-Phase-Hz	208/230-1-60
Minimum Circuit Amps.	5.2
INDOOR COIL TYPE	Plate Fin
Rows	4
Tube Size	9/32
Refrigerant Control	TXV
Drain Connection Size (in.)	3/4 NPT
Duct Connections	See Outline Drawing
INDOOR FAN TYPE	Centrifugal
Blower Diameter-Width (in.)	11 X 10-5/8
Fan Motor Type	ECM
CFM vs. in. W.G	See Fan Performance Table
Fan Motor HP	1/2
FLA	4.1
Filter Size (in.)	20*19 (19*19)
Filter equipped from factory	NO
Refrigerant	R-410A
Ref. Pipe Connections	Brazed
Liquid Pipe Size (in. O.D.)	3/8
Gas Pipe Size (in. O.D.)	3/4
Dimensions (W X H X D)	21 × 46-1/2 × 21
Net Weight (LBS)	121
Shipping Weight (LBS)	154

Product Specifications (Continued)

FAN SPEED	Sound pressure level (dB)
High	63
Medium High	61
Low	58

Model Number	Motor Speed	CFM (Watts)										
		External Static Pressure-Inches W.C.[KPa]										
		0 [0]	0.1 [0.02]	0.16 [.04]	0.2 [0.05]	0.3 [0.07]	0.4 [0.10]	0.5 [0.12]	0.6 [0.15]	0.7 [0.17]	0.8 [0.20]	
36	Tap (5)	SCFM	1455	1409	1374	1355	1320	1266	1229	1173	1126	956
		Watts	293	300	306	309	316	326	331	338	346	370
	Tap (4)	SCFM	1350	1302	1264	1242	1206	1145	1104	1038	897	824
		Watts	238	243	254	257	260	271	277	286	303	308
	Tap (3) - factory	SCFM	1328	1281	1234	1215	1179	1118	1073	1007	862	798
		Watts	226	232	239	242	250	259	264	278	292	298
	Tap (2)	SCFM	1235	1171	1130	1108	1062	1002	955	824	752	713
		Watts	185	189	196	199	205	214	221	238	245	248
	Tap (1)	SCFM	1146	1091	1044	1022	982	908	823	748	708	---
		Watts	150	156	163	167	174	184	196	202	207	---

Heater Kit Model	Electric Heater (kW)	MIN. Circuit Ampacity		MAX. Fuse or Breaker (HACR) Ampacity		Fan Speed				
		240	208	240	208	1	2	3	4	5
E-EHK05	5	25	22	30	25	×	●	●	●	●
E-EHK10	10	49	43	60	50	×	×	●	●	●
E-EHK15	5+10	25+49	22+43	30+60	25+50	×	×	●	●	●

Mechanical Specifications

1. Multi-position Installation. (Vertical up-flow and horizontal right-flow from factory; field convertible to horizontal left-flow or vertical down-flow *Refer to installation manual for details)
2. Multiple electrical entry locations.
3. Field installed heater kits 5,10, 15KW.
4. Dual front panel design for ease of maintenance.
5. ECM 3 speed options (Tap 3 - Tap 5) in the job site. Two-stage speed is available to get even better dehumidification control if cooperating with Ecoer thermostat.
6. Blower and coil easy slide out design for ease of maintenance.
7. Horizontal and vertical condensate drain pans.
8. Condensate drain is polymer with UVC inhibitor.
9. Primary and secondary condensate drain fittings.

