



Multi-position Air Handler
EAHATN-24

TAG:

SUBMITTAL

NOTE: 25" CLEARANCE IS REQUIRED IN THE FRONT OF THE UNIT FOR FILTER AND COIL MAINTENANCE.

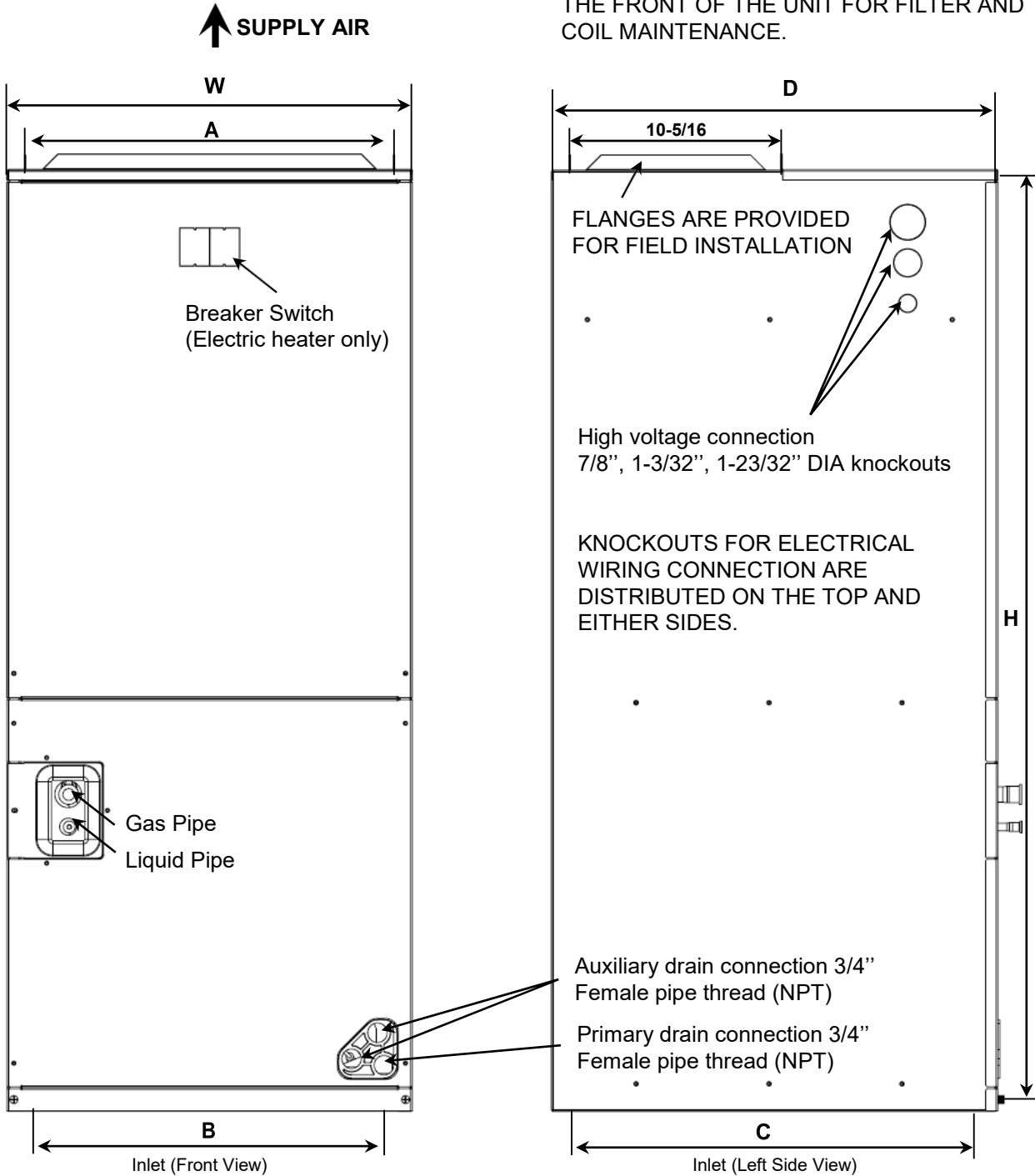

Model	Dimensions (in.)					
	H	W	D	A	B	C
EAHATN-24	46-1/2	21	21	19-1/4	13-7/8	16

Product Specifications

MODEL	EAHATN-24
Voltage-Phase-Hz	208/230-1-60
Minimum Circuit Amps.	3.0
INDOOR COIL TYPE	Plate Fin
Rows	4
Tube Size	9/32
Refrigerant Control	TXV
Drain Connection Size (in.)	3/4 NPT
Duct Connections	See Outline Drawing
INDOOR FAN TYPE	Centrifugal
Blower Diameter-Width (in.)	10 X 8
Fan Motor Type	ECM
CFM vs. in. W.G	See Fan Performance Table
Fan Motor HP	1/3
FLA	2.4
Filter Size (in.)	20*19 (19*19)
Filter equipped from factory	NO
Refrigerant	R-410A
Ref. Pipe Connections	Brazed
Liquid Pipe Size (in. O.D.)	3/8
Gas Pipe Size (in. O.D.)	3/4
Dimensions (W X H X D)	21 × 46-1/2 × 21
Net Weight (LBS)	119
Shipping Weight (LBS)	150

Product Specifications (Continued)

FAN SPEED	Sound pressure level (dB)
High	60
Medium High	57
Low	53

Model Number	Motor Speed	CFM (Watts)										
		External Static Pressure-Inches W.C.[KPa]										
		0 [0]	0.1 [0.02]	0.16 [.04]	0.2 [0.05]	0.3 [0.07]	0.4 [0.10]	0.5 [0.12]	0.6 [0.15]	0.7 [0.17]	0.8 [0.20]	
24	Tap (5)	SCFM	1062	1031	998	981	947	901	869	823	789	742
		Watts	184	195	201	203	213	222	228	238	242	252
	Tap (4)	SCFM	959	921	890	873	836	786	751	706	677	622
		Watts	138	145	152	156	162	171	178	188	196	204
	Tap (3) - factory	SCFM	855	825	790	769	733	679	646	595	560	494
		Watts	101	111	118	120	126	134	141	151	156	166
	Tap (2)	SCFM	777	750	712	692	656	599	566	498	466	412
		Watts	80	89	96	98	104	113	119	127	135	145
	Tap (1)	SCFM	694	663	620	599	562	499	455	390	---	---
		Watts	60	68	74	76	82	89	95	104	---	---

Heater Kit Model	Electric Heater (kW)	MIN. Circuit Ampacity		MAX. Fuse or Breaker (HACR) Ampacity		Fan Speed				
		240	208	240	208	1	2	3	4	5
E-EHK05	5	25	22	30	25	x	●	●	●	●
E-EHK10	10	49	43	60	50	x	x	●	●	●

Mechanical Specifications

1. Multi-position Installation. (Vertical up-flow and horizontal right-flow from factory; field convertible to horizontal left-flow or vertical down-flow *Refer to installation manual for details)
2. Multiple electrical entry locations.
3. Field installed heater kits 5,10KW.
4. Dual front panel design for ease of maintenance.
5. ECM 3 speed options (Tap 3 - Tap 5) in the job site. Two-stage speed is available to get even better dehumidification control if cooperating with Ecoer thermostat.
6. Blower and coil easy slide out design for ease of maintenance.
7. Horizontal and vertical condensate drain pans.
8. Condensate drain is polymer with UVC inhibitor.
9. Primary and secondary condensate drain fittings.

